

Mary Sullivan
From the Inside Out and the Outside In
 11 November to 23 December 2023

1. *The Red Line I*
 stainless steel, glass, polysiloxane, 2023

2. *The Red Line II*
 wood, stone coating, 2023

3. *From the Outside In I*
 weathered steel, 2023

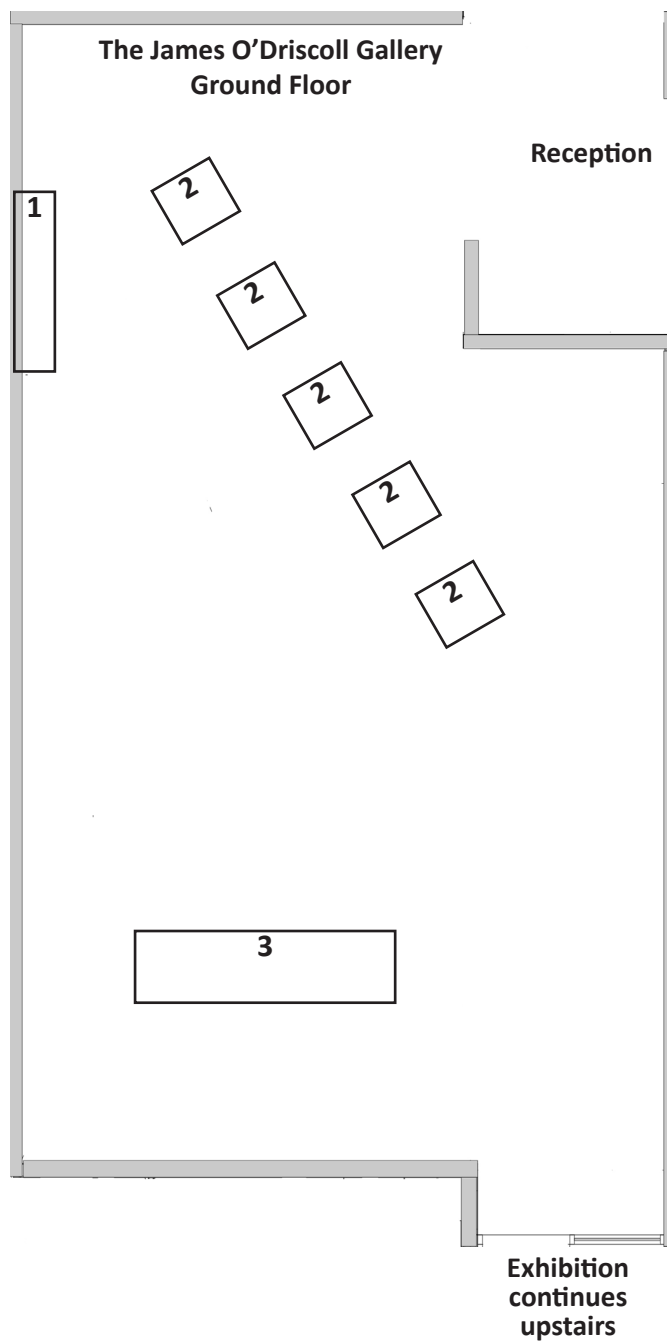
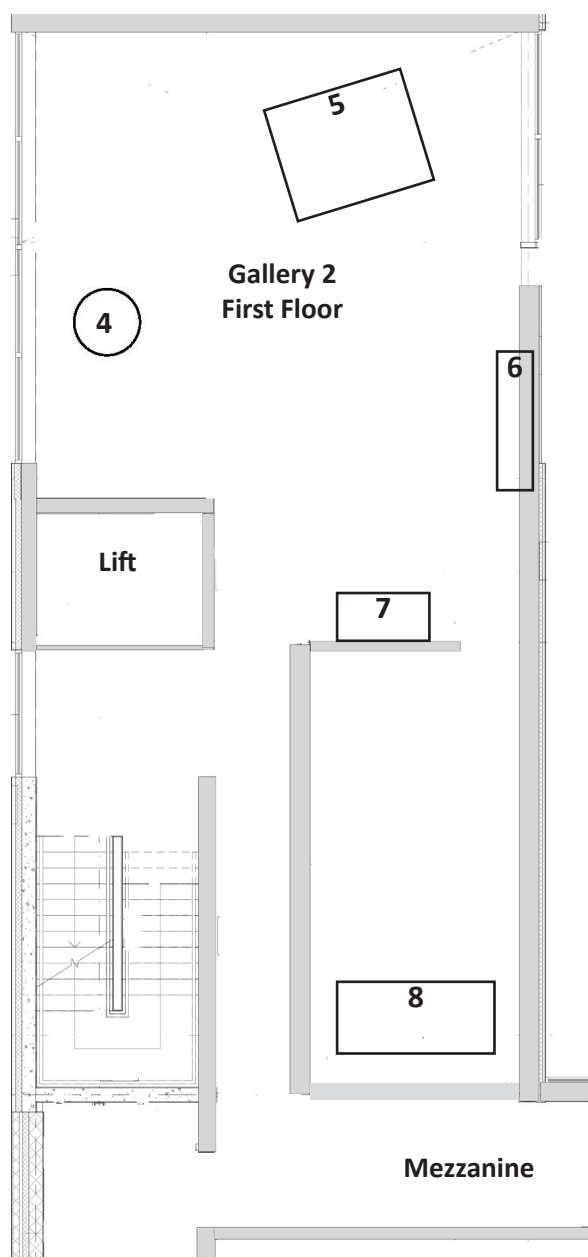

4. *Glass Houses*
 steel table, glass plate, 89 glass spheres, 2022

5. *From the Outside In II*
 steel frame, 8 aluminium blinds, 2023

6. *Routes/Roots II*
 wood, metal, 2023

7. *Routes/Roots I*
 video, 10 mins, 2023

8. *The Fine Line*
 video, 4.1 mins, 2022

Mary Sullivan lives and works on Bere Island, off the south coast of Ireland. Her work turns a critical lens on the complex history of women's labour, island life and identity.

From the Inside Out and the Outside In is a new body of work which started as a direct response to observations of the community of Bere Island during the initial Covid -19 lockdown in 2020. The work focuses on the fragility of the island people while at the same time highlighting their strength and resilience. This exploration is set against the backdrop of Mary's previous work around gendered labour, female narratives and the military sites on Bere Island including *At Home, At War* which won the RDS Taylor award in 2018.

Glass Houses comprises 89 hollow glass spheres, those 8cm in diameter representing single occupancy homes on Bere Island and 10cm representing multi-occupancy homes. Glass is used to represent the strength of island networks at a time of extreme social isolation and fragmentation, while also highlighting their fragility. The spheres also reference the fishing tradition of using hand-blown, hollow glass spheres instead of corks or other buoyant materials to float nets. The spheres are placed on a tinted glass disc, with circular holes cut into it anchoring each sphere in position, denoting the locations of each dwelling on Bere Island. The artwork sits on a steel structure, giving the illusion of the disk floating like an island.

The performance video *The Fine Line* focuses on the often unseen labour, resilience and self-reliance of island women over generations and continuing to this day, while the video work *Routes/Roots I* and the drawing *Routes/Roots II* address the often romanticised but necessary journeys that island people take to go about their everyday lives, sea crossings that are dictated by ferry timetables, tides and weather.

The military occupation of Bere Island is a recurring theme of Mary's work and she continually explores the former military buildings and sites to actively engage with particular experiences of life as lived from a domestic, female and island perspective. References to the influence of the British military on the island include *The Red Line I* and *The Red Line II* which relate to the structures marking the boundary that was imposed in the early 1900s to exclude islanders from the military areas. Everything east of 'the red line' was purchased by the British military placing everyone that occupied that part of island on a temporary lease where occupants were considered a 'tenant at will' subject to eviction at 24 hours-notice.

Mary says '*Reminiscent of my feelings and experiences upon first moving to Bere Island, the eight works in this exhibition are shaped by my understanding of island life as being simultaneously defined by openness and limitations, community and autonomy, roots and routes.*'

Mary Sullivan graduated from the BA (hons) Visual Art Degree Programme, Sherkin Island in 2018. She was the first recipient of the RDS Taylor Art Award as a graduating student from TU Dublin for her work *At Home, At War*. Mary has exhibited in institutions in Ireland and the United Kingdom, most notably in the RHA (Royal Hibernian Academy) Gallery, Dublin and at The Leydon Gallery, London. In 2019, she produced and exhibited her debut solo exhibition *Breathe* in the underground rooms of a disused military shelter on Bere Island which received critical acclaim. In 2019, she was awarded the Graduate Research and Development Award with mentoring from artist Jesse Jones by Create, Ireland's national development agency for collaborative arts. She is also the recipient of awards from Cork County Council and the Arts Council / An Chomhairle Ealaíon.

This exhibition is supported by the Arts Council /An Chomhairle Ealaíon, a Cork County Council Arts Bursary and Creative Places: The West Cork Islands.



Comhairle Contae Chorcaí
Cork County Council

